

# FLT25 probe

ULTRASONIC FLOWMETER INSERTION TYPE

*For Pipes Under pressure*



- **Single point flow measurement for pressurized pipes\***
- **Can measure flow for all kinds of homogeneous fluids**
- **For all kind of pipes material with diameters between 40 and 5,000mm ND**
- **Easy installation using 25mm (1") standard tapping systems**
- **Operate with FLT 10 converter**

\*Open channel compatible



Concrete pipe ND 1,200mm

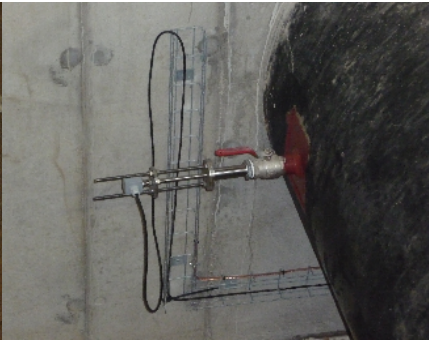

Concrete pipe ND 1,200mm



Concrete pipe ND 2,800 mm



A **FLOW-LAB**  
Technologies

[www.boontec.com.au](http://www.boontec.com.au)

## Technical Features

**FLT 25**  
Standard Length  
500mm

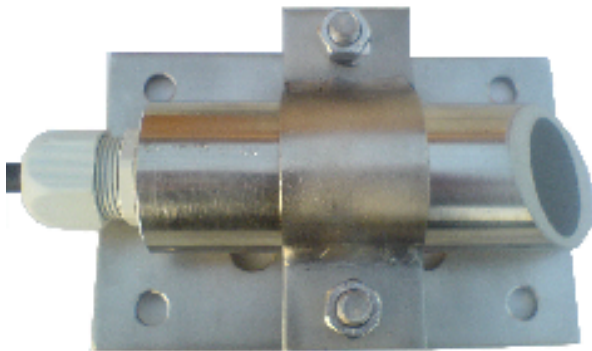
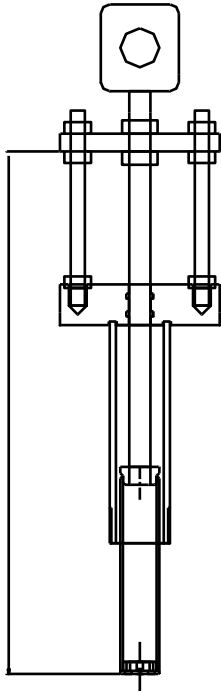

Version FLT25oc for Open Channel

The **FLT25** is a **bi-directional intrusive ultrasonic sensor** for measuring flow with **high accuracy** (better than 1%) in **all kind of homogeneous fluids** (transparent to US waves) and all kind of pipes material, under pressure. Available with dual sensors (mono-chord) or multi-sensors (multi-chords) depending on applications. (Version **FLT25 OC** available for open channels)

It's given significant advantages compares to traditional full bore EM sensors:

- No interruption of supply.
- High accuracy.
- None or reduced civil works (e.g. Manholes).
- Easy installation using standard under pressure taping systems
- Suitable installation on pipes from ND 40 (1 ½") up to ND 5000 (200") and more.
- Standard probes mountings are compatible with taping connectors (welded/thread) or saddles from the shelves using 1" standard stop or taping valves for insertion.

### **Key figures:**

- Body's probe Ø 24 mm
- Body's material: 316 L stainless steel
- Standard Operating pressure 25 bars (special up to 90 bar)
- Working temperature -20 to + 70° C
- IP 68 grade
- Weight 6 Kg
- Dimensions 500 X 90X 80 mm

### **Performances**

- Measure bandwidth: 0.1 m/s to 10 m/s
- Accuracy: more than 1% from 0.1m/s to 10 m/s
- Linearity: 0.1 % (automatic zero)